

# Unit Information

220-240 volts – 50/60 Hz – 1200 Watts

# WARING COMMERCIAL®

Europe Gelato Panini Press

## WWGP180E



Date Code Location  
YY|MM|DD  
year|year|month|month|day|day

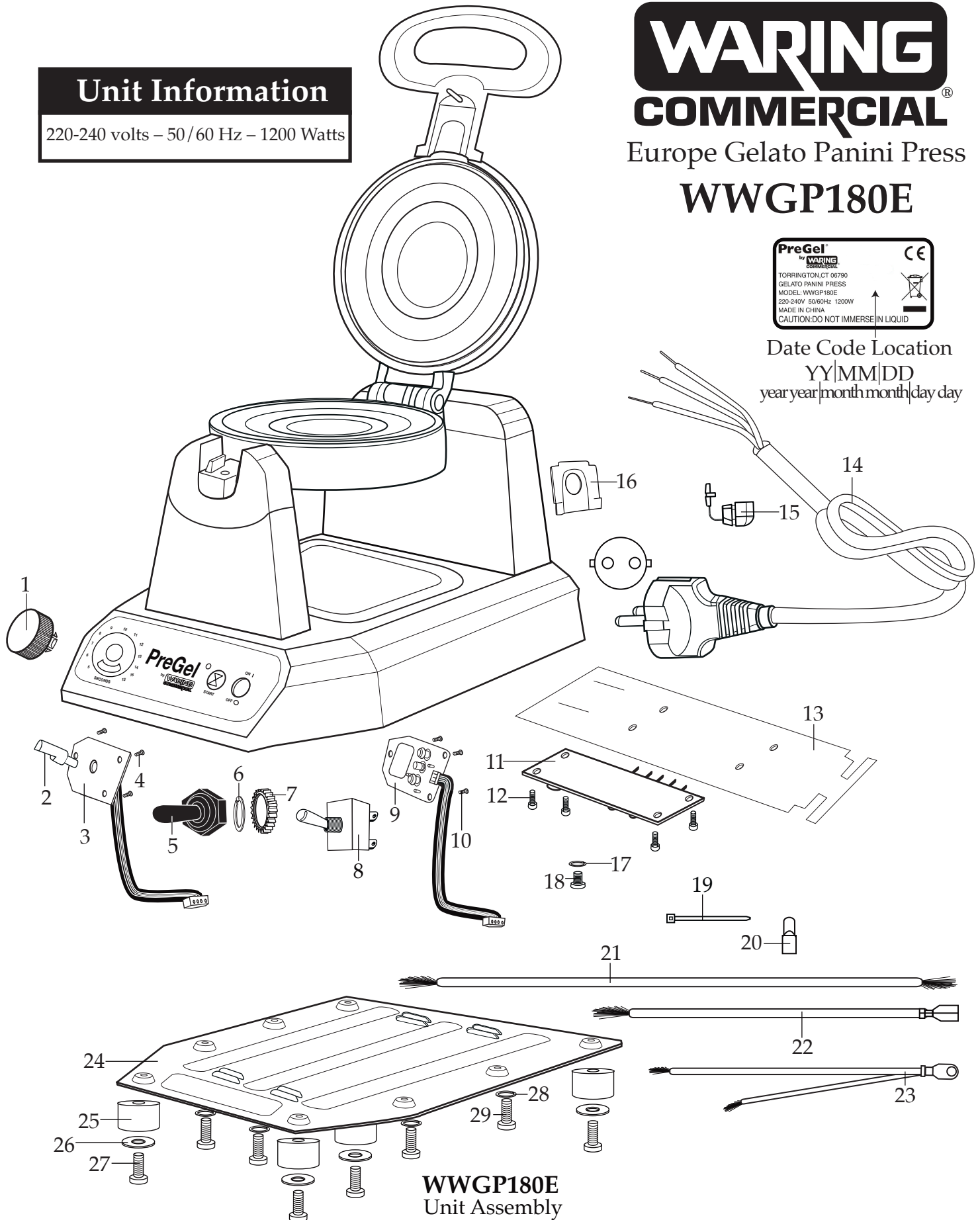

**WWGP180E**  
Unit Assembly



Illustration#	Part#	Description
1	034157	Control Knob
2	034162	Connection Pole
3	035316	Darkness Control Panel (thermostat) w/ Short Lead Tape
4	032359	Screw (3 required)
5	035321	Toggle Switch Boot
6	032356	Washer
7	035322	Toggle Switch Locking Ring
8	032747	ON-OFF Toggle Switch
9	035343	Control Board
10	032359	Screw (3 required)
11	035344	PCB Board
12	032359	Screw (4 required)
13	030638	PCB Board Shield
14	032748	Cord Set
15	032361	Strain Relief
16	032371	Cord Plate
17	032360	Ground Spring Washer
18	035298	Ground Screw
19	013731	Wire Tie (7 required)
20	019123	Large Crimp Connector
	012409	Small Crimp Connector (5 required)
21	032367	17" Red Lead
22	034932	7.5" Red Lead
23	035345	Double Ground Lead
24	032351	Bottom Plate
25	032353	Foot (4 required)
26	032354	Foot Washer (4 required)
27	032355	Foot Screw (4 required)
28	032360	Bottom Plate Spring Washer (4 required)
29	032750	Bottom Plate Screw (4 required)